



NEPTUNE WHARF

INDICATIVE

2 BEDROOM APARTMENT

[NEPTUNEWHARFLONDON.COM](https://neptunewharflondon.com)

IN YOUR

2 BEDROOM APARTMENT

Calm and contemporary, our two-bedroom lateral apartments offer seamless single-level living with an emphasis on space and light. Open-plan layouts create a natural flow between living, dining, and kitchen areas, while well-proportioned bedrooms provide a restful retreat. Designed with comfort and modern living in mind, these homes combine elegant simplicity with practical style.

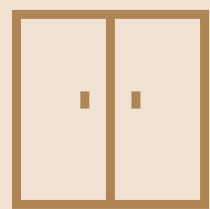

FULLY FITTED
WARDROBES



SMEG INTEGRATED
APPLIANCES



FREE 1GB
WI-FI



PRIVATE
BALCONY



KITCHEN
ISLAND*



INSTA-BOIL
TAP

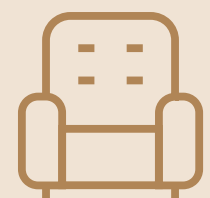

FURNISHED OR
UNFURNISHED



FLOOR TO
CEILING WINDOWS

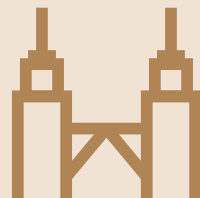

PARK & SKYLINE
VIEWS

*SUBJECT TO AVAILABILITY





INDICATIVE

2 BEDROOM

APARTMENT

01 LIVING/DINING

02 BEDROOM 1

03 BEDROOM 2

04 BATHROOM

05 BALCONY

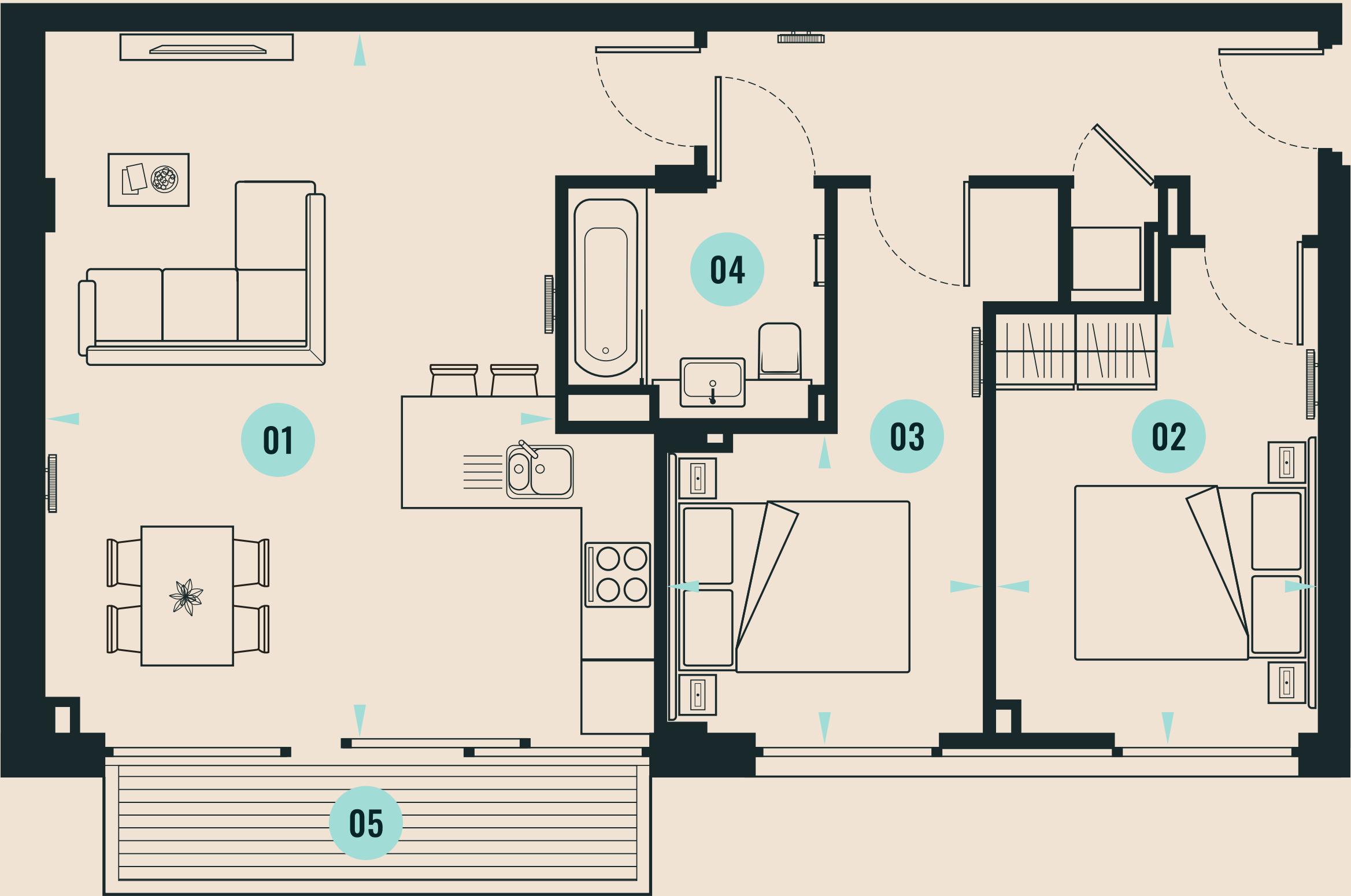

PHOTOGRAPHY IS INTENDED FOR ILLUSTRATIVE PURPOSES ONLY AND SHOULD BE TREATED AS GENERAL GUIDANCE ONLY. ALL THE PARTICULARS IN THIS BROCHURE WERE CORRECT AT TIME OF PRODUCTION.

Customers should note these illustrations are an example of this apartment type. Furniture layout is for illustrative purposes only. Homes may be 'handed' (mirror image) versions of the illustrations. Detailed plans and specifications are available for inspection for each unit type and customers must check their individual specifications prior to making a reservation.



YOUR NEW URBAN RETREAT

For more information or to arrange a viewing please
call 0203 770 2099 or email info@neptunewharflondon.com

[NEPTUNEWHARFLONDON.COM](https://neptunewharflondon.com)

NEPTUNE WHARF, GRINSTEAD ROAD, LONDON SE8 5FN



Join the community
[@neptunewharf](https://www.instagram.com/neptunewharf)

SABLE
CAPITAL

 DESIGNED BY SOCIETYSTUDIOS.CO.UK

PHOTOGRAPHY IS INTENDED FOR ILLUSTRATIVE PURPOSES ONLY AND
SHOULD BE TREATED AS GENERAL GUIDANCE ONLY. ALL THE PARTICULARS
IN THIS BROCHURE WERE CORRECT AT TIME OF PRODUCTION.

Galliard
Homes